

# TRANSFER2

USER GUIDE

# PARTS LIST

## HARDWARE INCLUDED

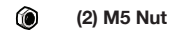
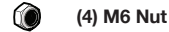
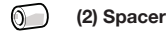
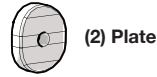
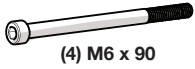

## PARTS INCLUDED

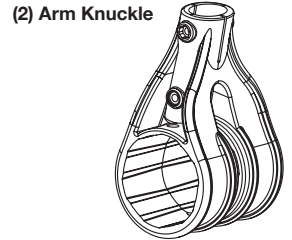
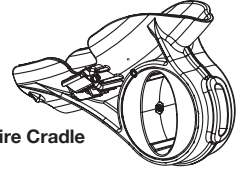
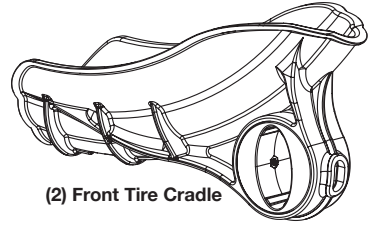

## TOOLS INCLUDED

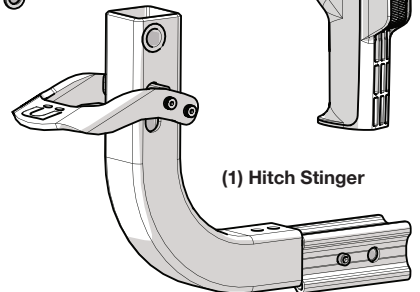
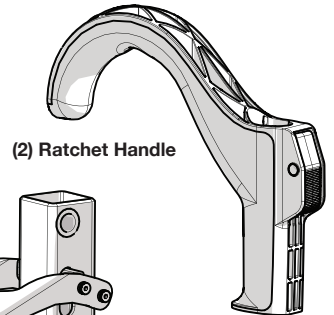
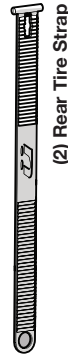
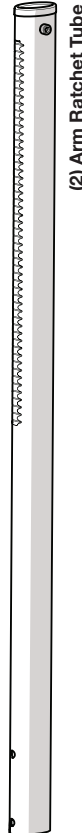
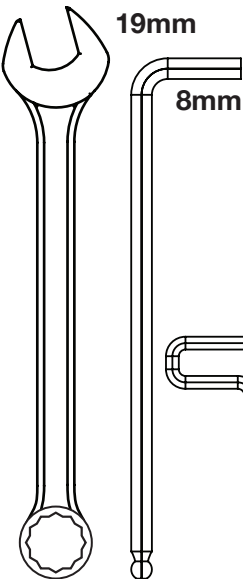

# ASSEMBLY INSTRUCTIONS

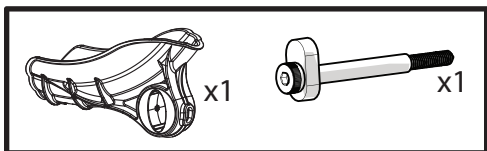

Front Tire Cradle

Locator Tab Bolt

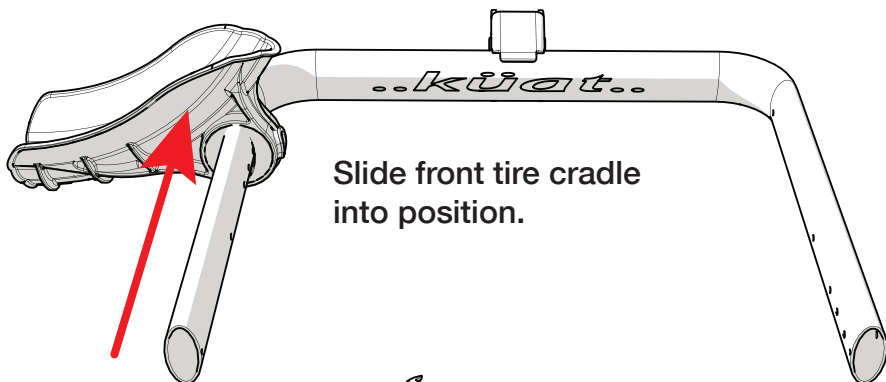

Slide front tire cradle into position.

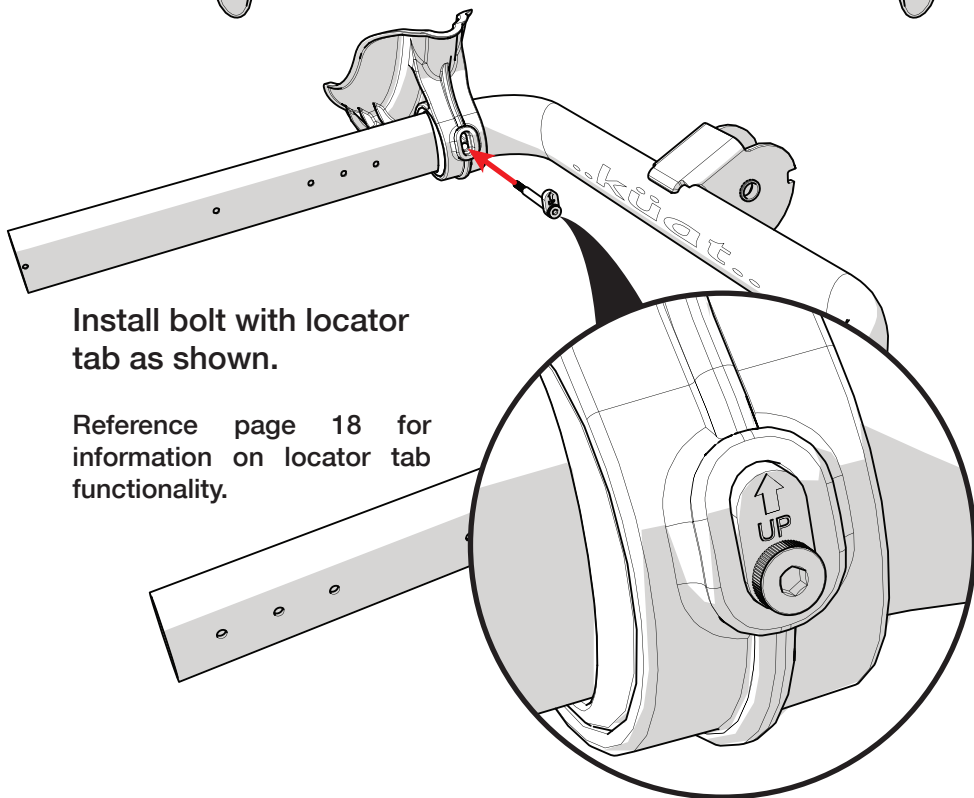

Install bolt with locator tab as shown.

Reference page 18 for information on locator tab functionality.

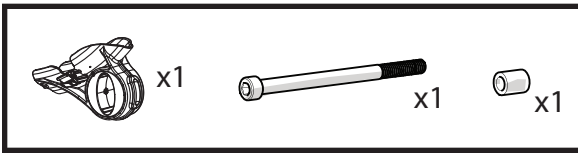

Rear Tire Cradle

M6 x 90

Spacer

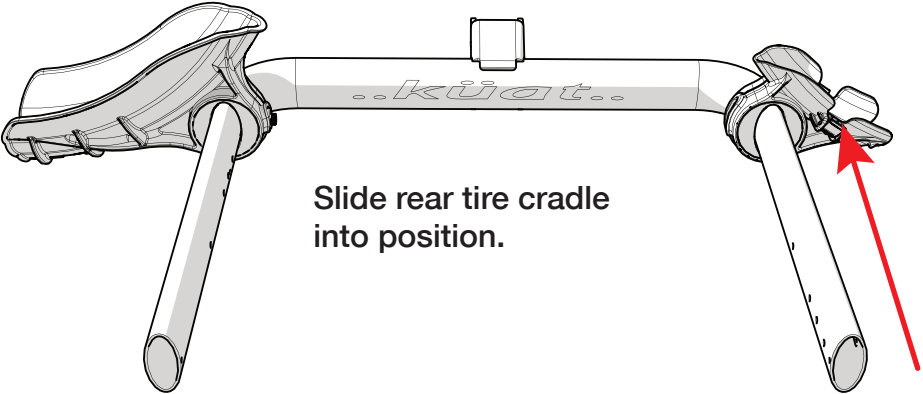

Slide rear tire cradle into position.

Secure with bolt and spacer.

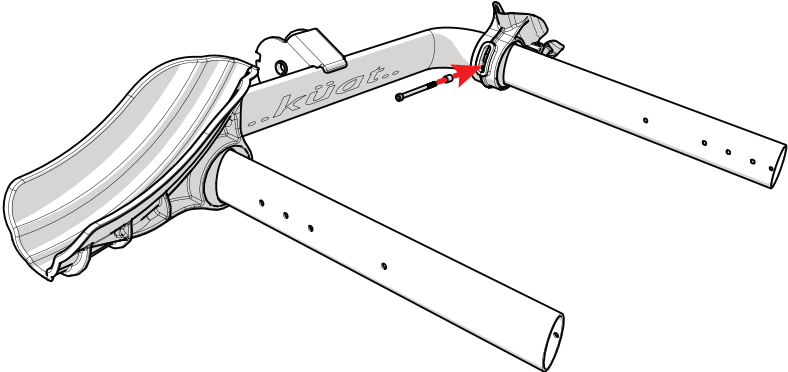

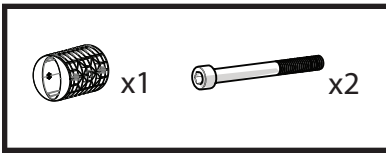

Arm Puck

M6 x 60

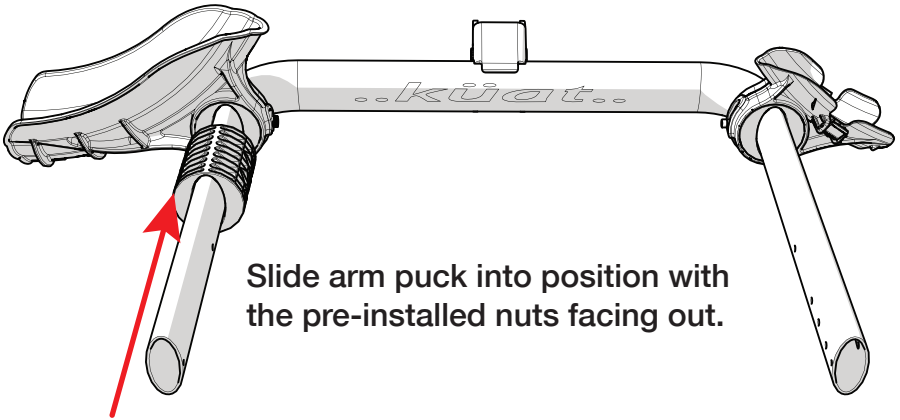

Slide arm puck into position with the pre-installed nuts facing out.

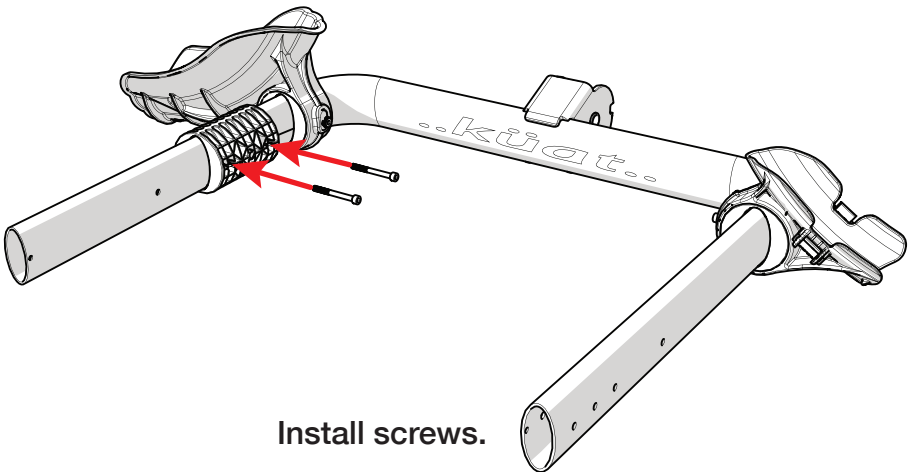

Install screws.

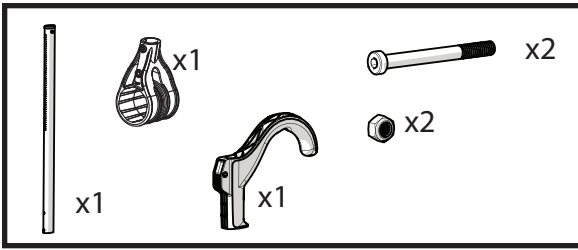

- Arm Ratchet Tube
- Arm Knuckle
- Ratchet Handle
- M6 x 60 Low Profile
- M6 Nut

Assemble tire hook arm.  
**NOTE:** Use arm without Küat logo.

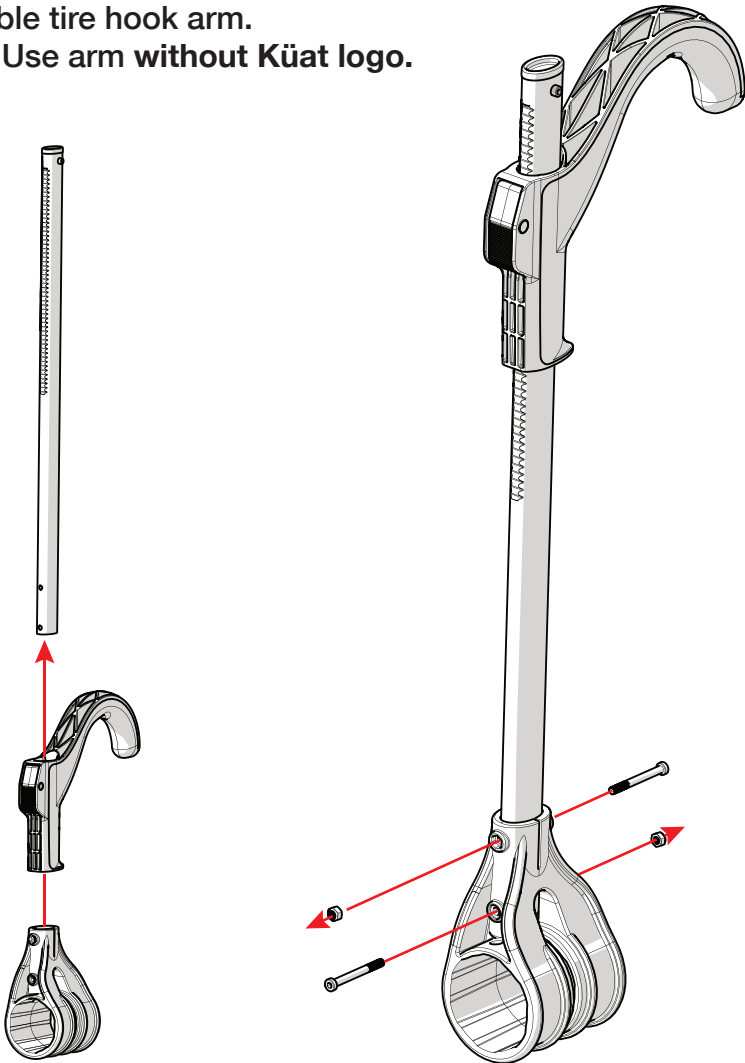

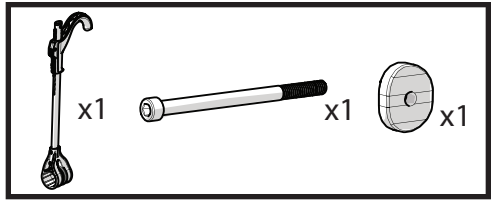

Assembled Arm

M6 x 90

Plate

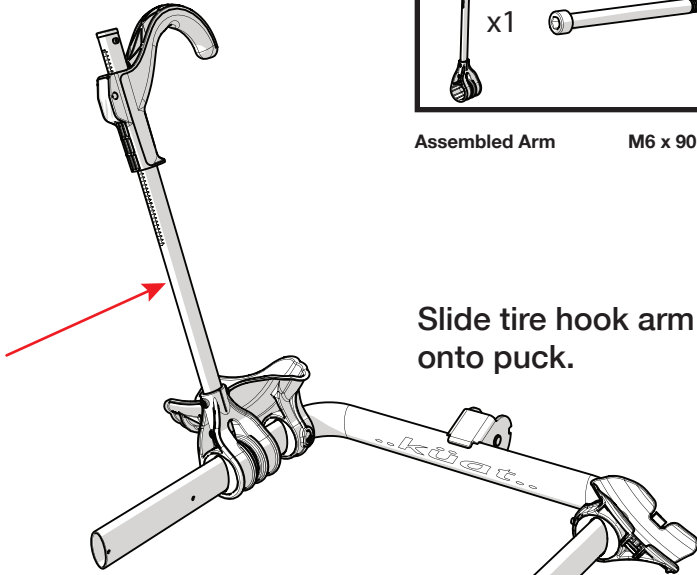

Slide tire hook arm onto puck.

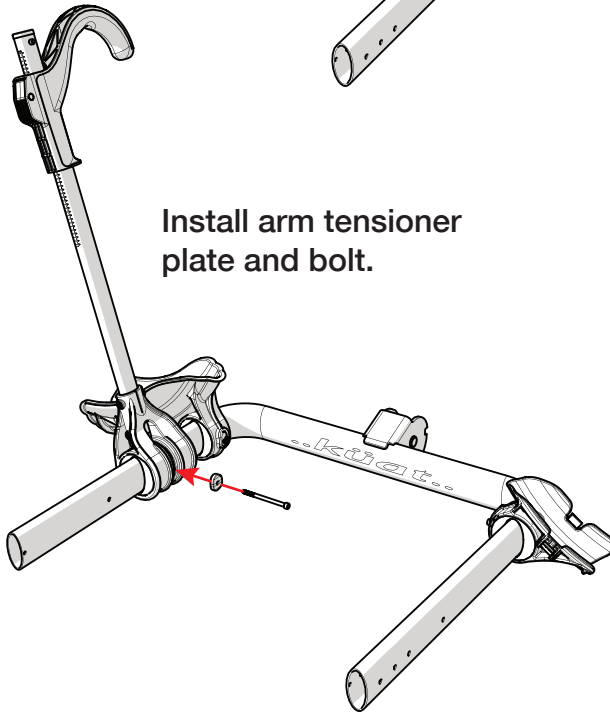

Install arm tensioner plate and bolt.

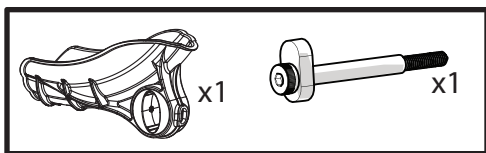

Front Tire Cradle

Locator Tab Bolt

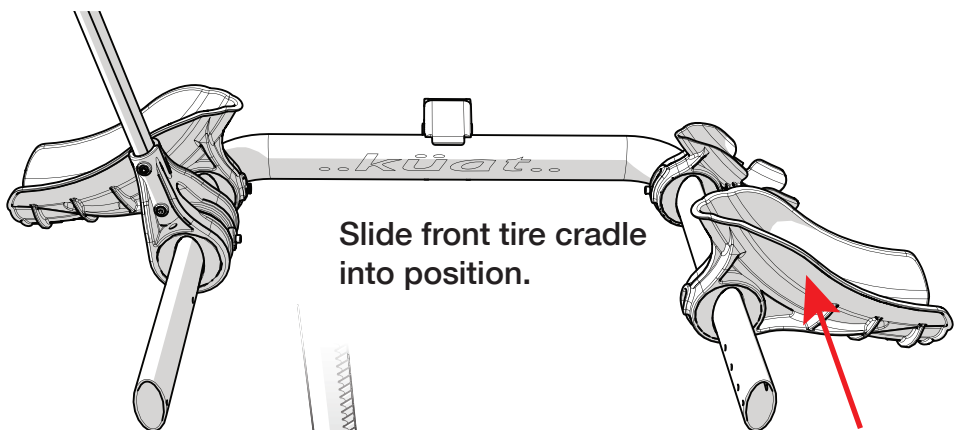

Slide front tire cradle into position.

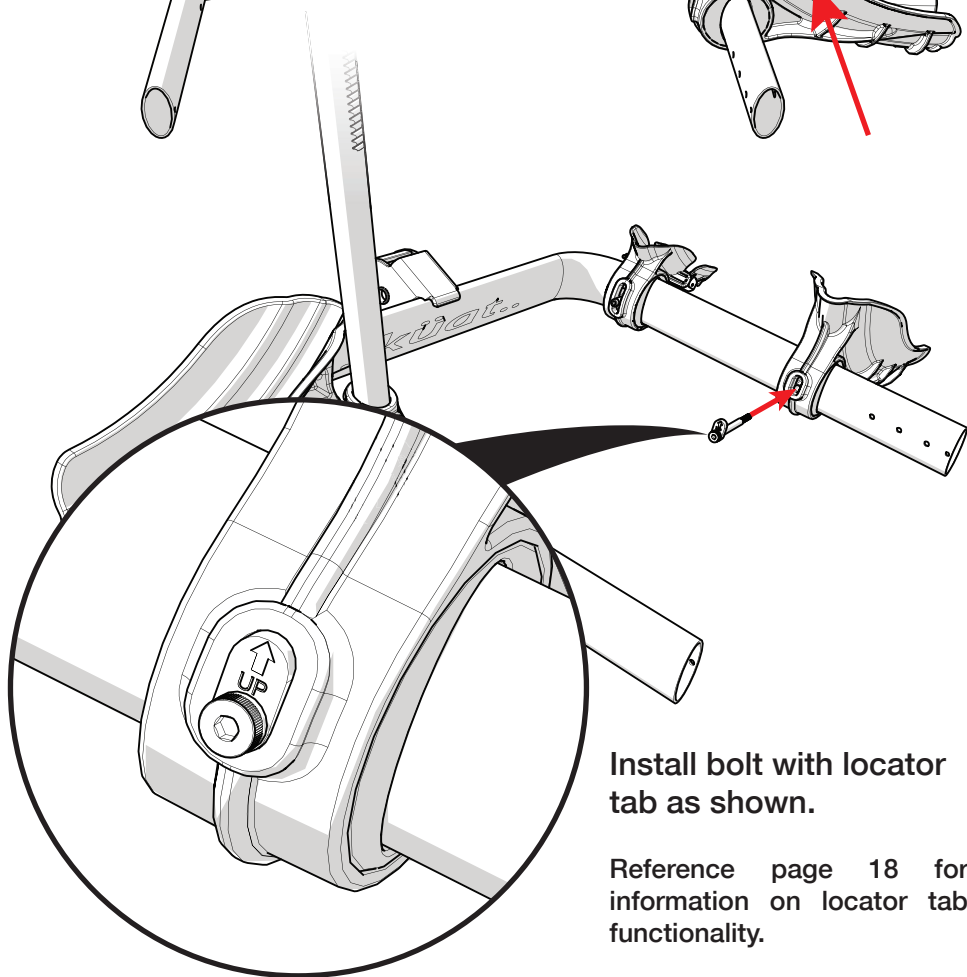

Install bolt with locator tab as shown.

Reference page 18 for information on locator tab functionality.



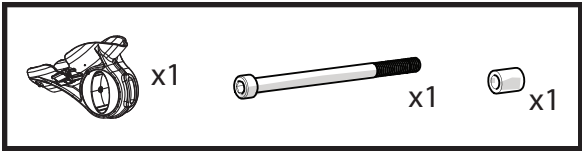

Rear Tire Cradle

M6 x 90

Spacer

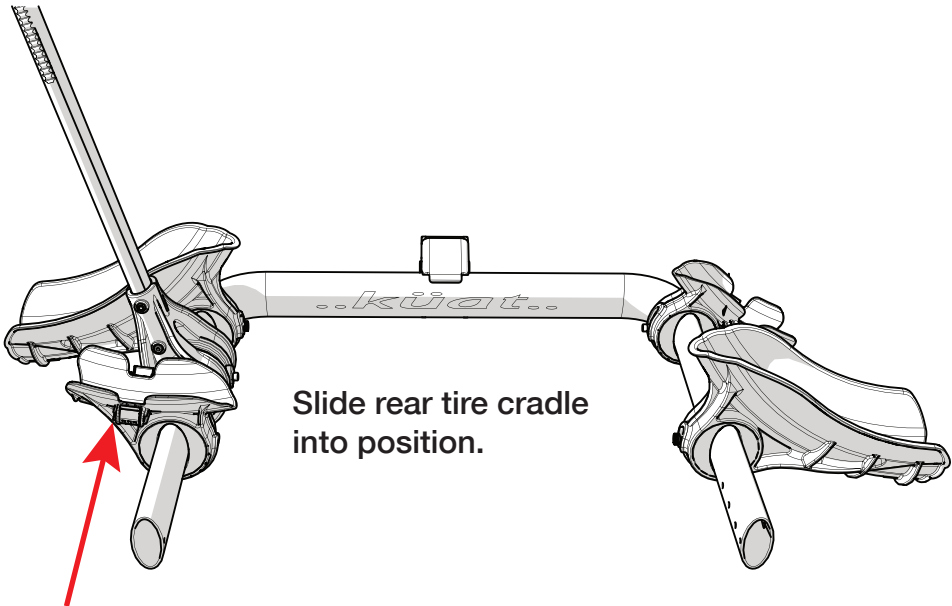

Slide rear tire cradle into position.

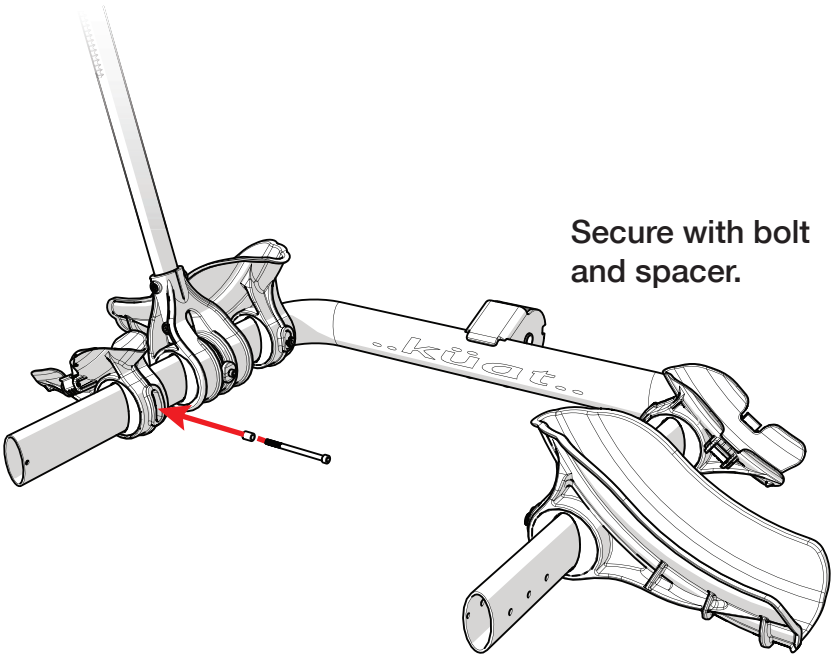

Secure with bolt and spacer.

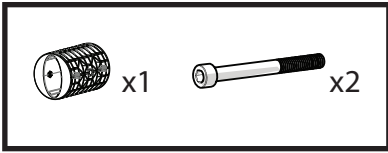

Arm Puck

M6 x 60

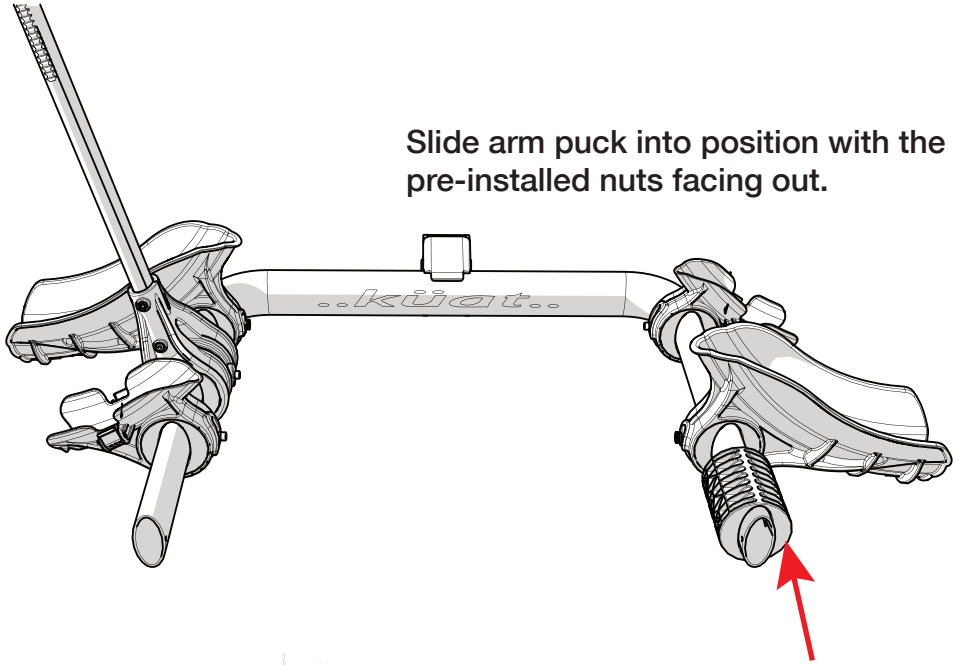

Slide arm puck into position with the pre-installed nuts facing out.

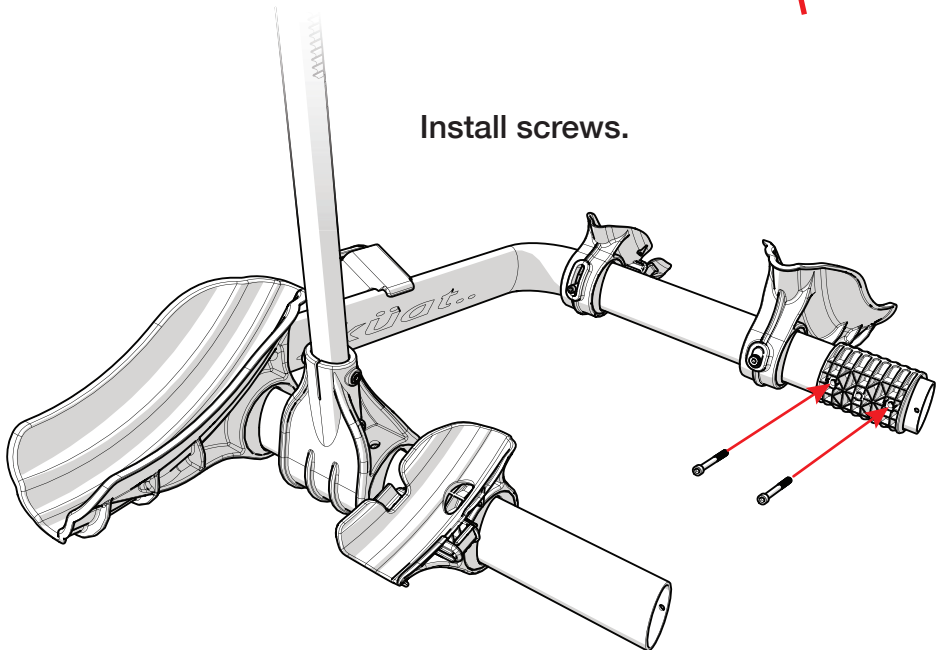

Install screws.

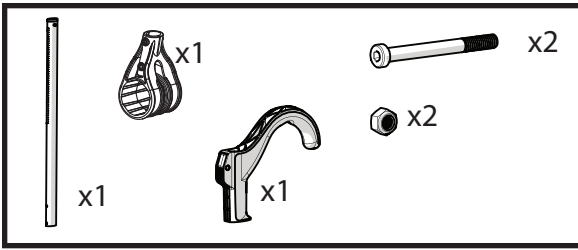

Arm Ratchet Tube  
 Arm Knuckle  
 Ratchet Handle  
 M6 x 60 Low Profile  
 M6 Nut

Assemble tire hook arm.  
**NOTE:** Use arm with Küat logo.

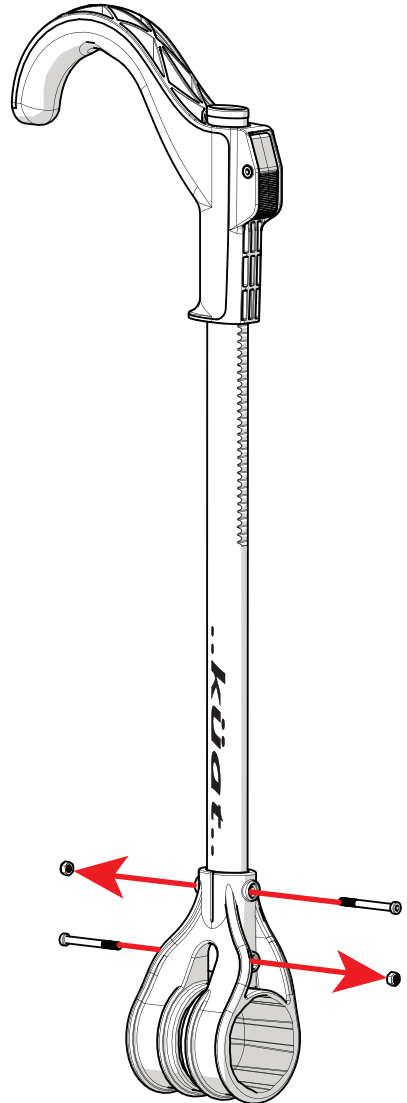
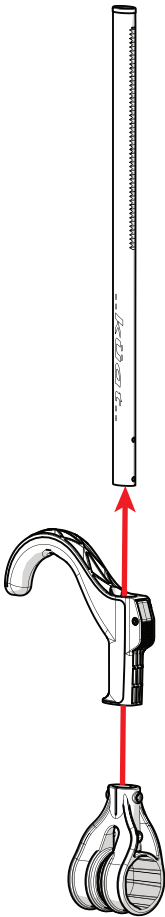

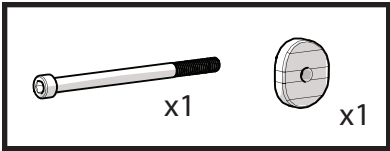

M6 x 90

Plate

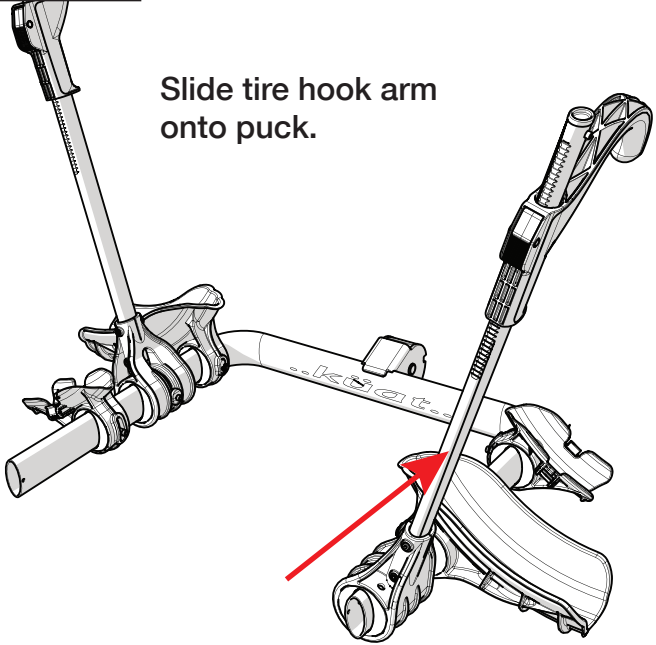

Slide tire hook arm onto puck.

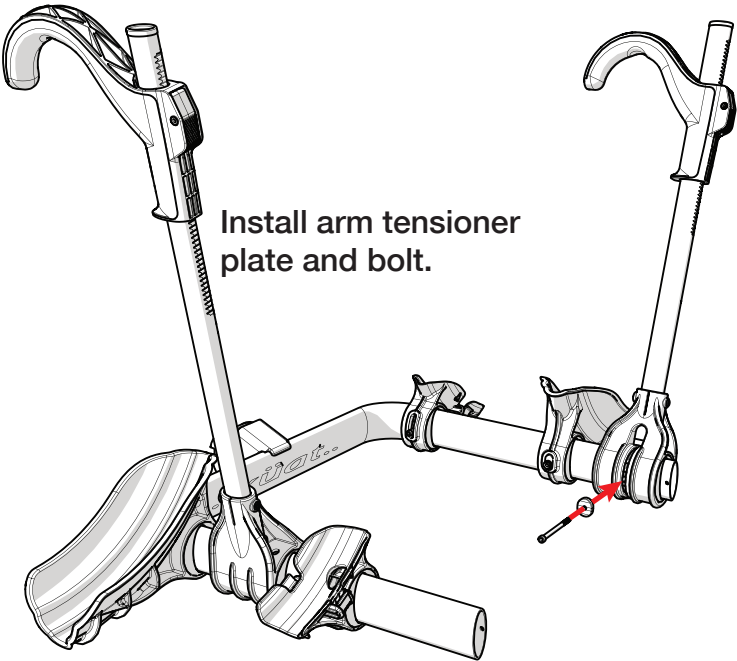

Install arm tensioner plate and bolt.

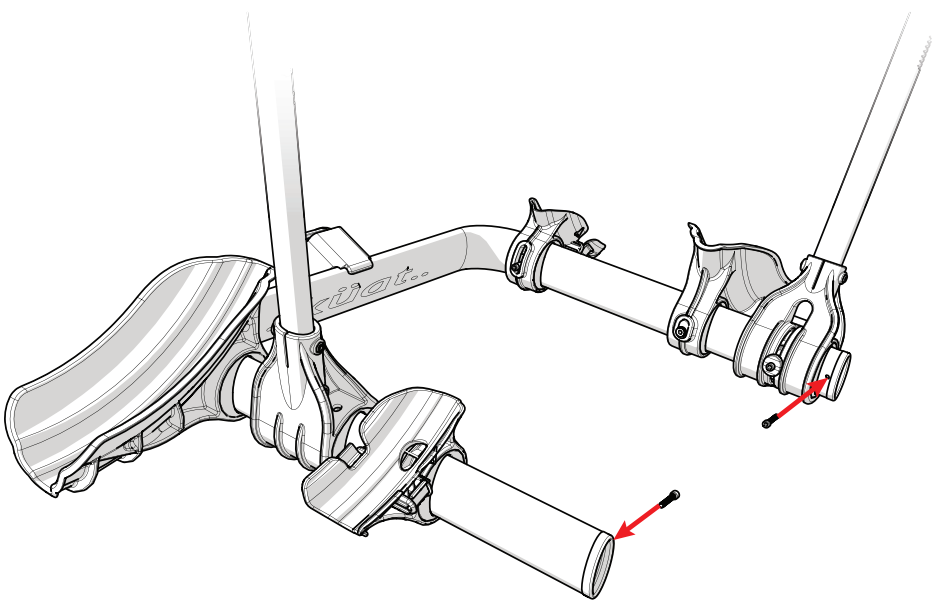
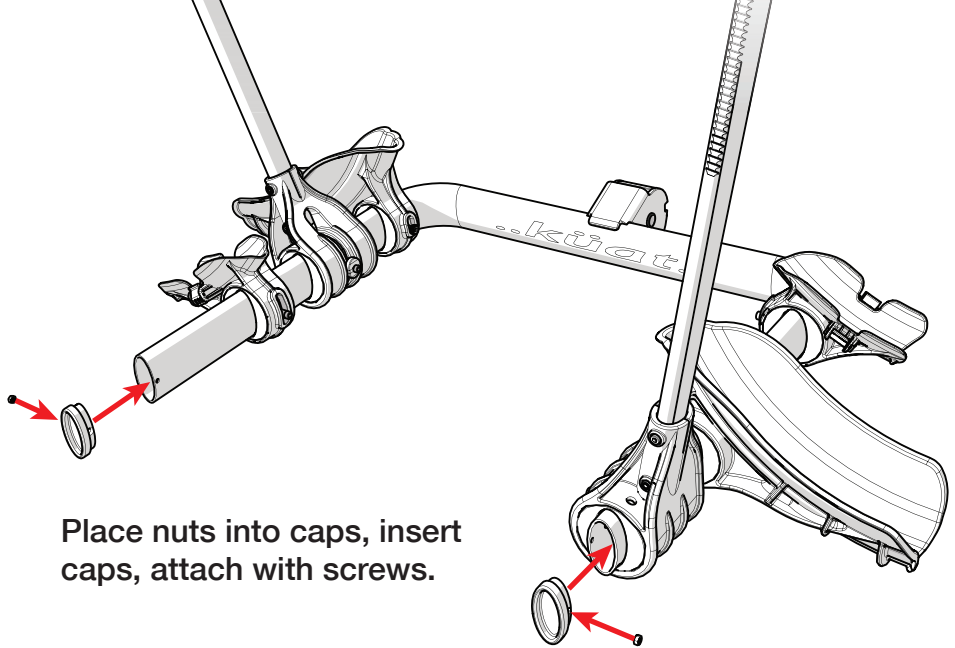
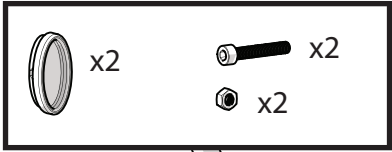

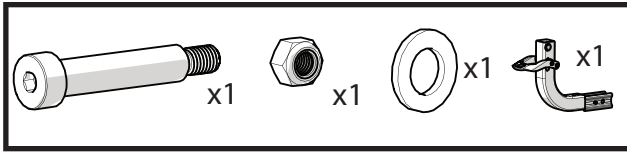

Pivot Bolt  
Pivot Nut  
Pivot Washer  
Hitch Shank

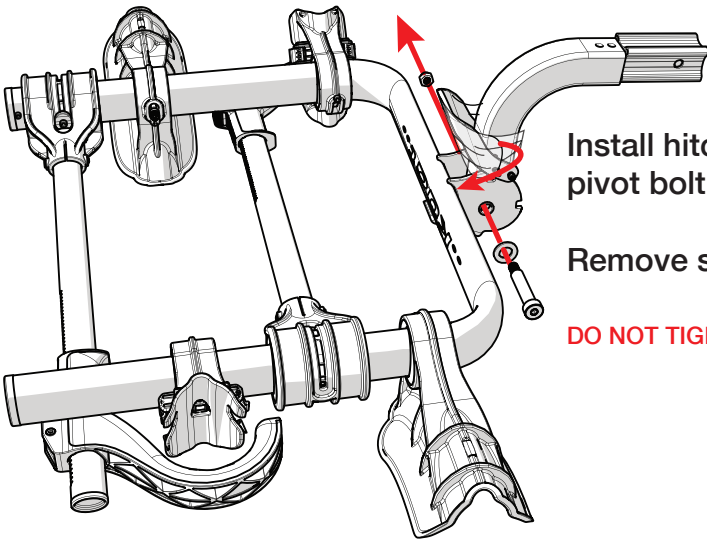

Install hitch shank with pivot bolt, washer and nut.

Remove stretch wrap.

**DO NOT TIGHTEN PEDAL BOLTS**

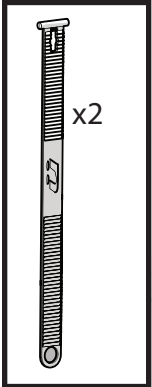

Tire strap

Thread tire strap through both ratchets.  
Open side should face end caps.

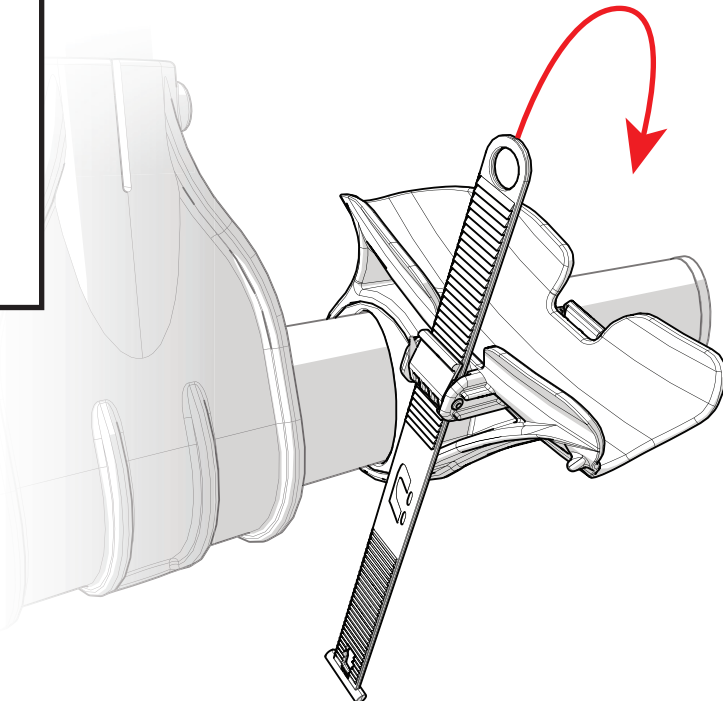

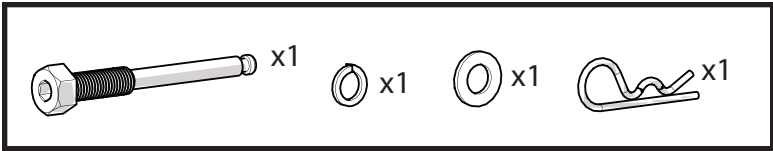

Hitch Bolt  
Lock Washer  
Washer  
Cotter Pin

Insert rack into hitch.

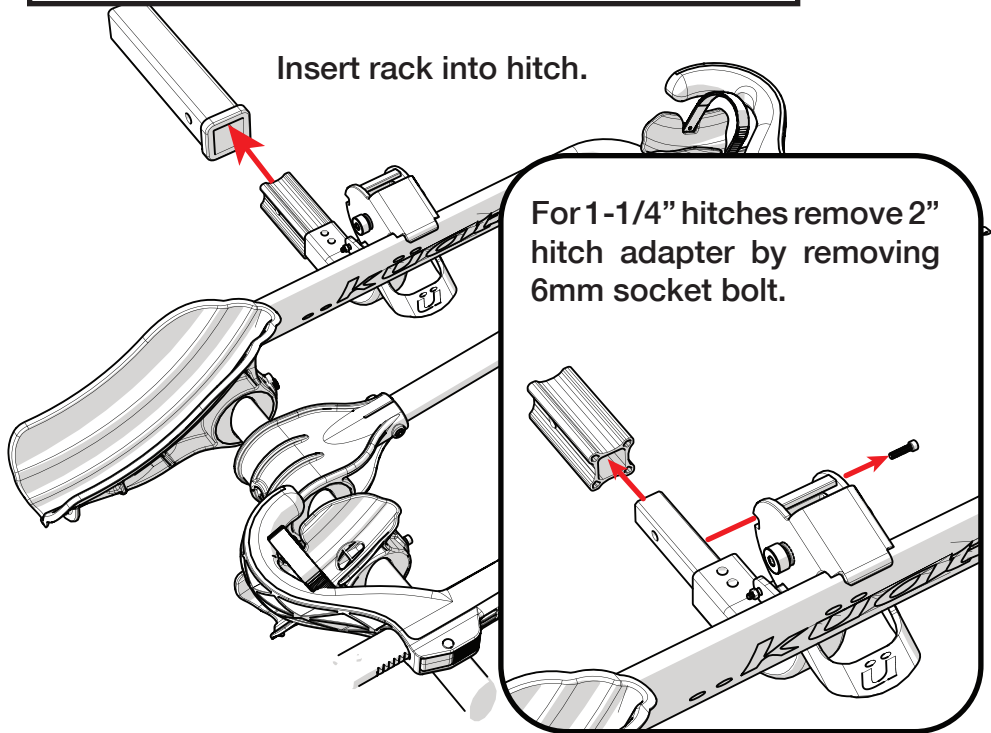

Thread the hitch bolt with washers into the hitch, secure bolt with cotter pin. Tighten with 8mm allen or 9mm box wrench.

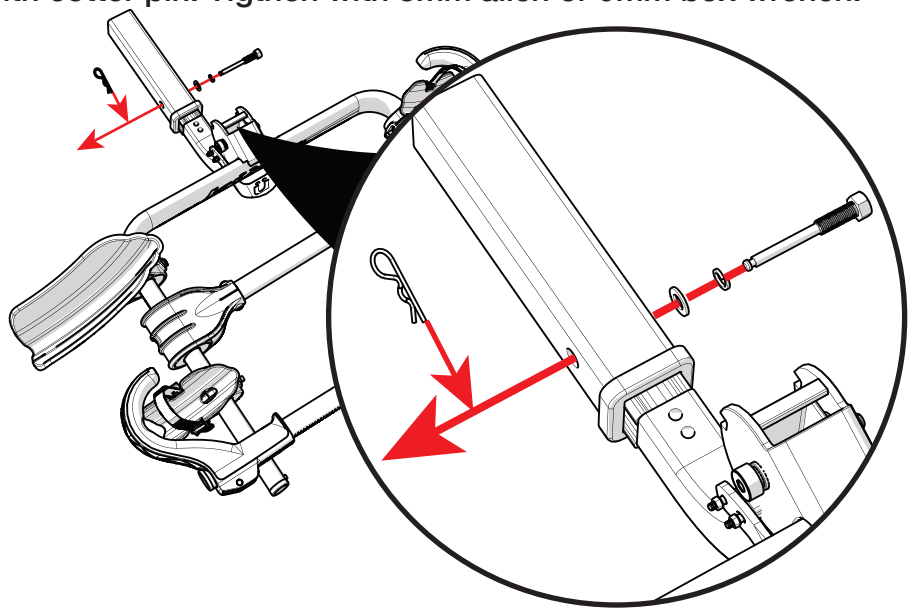

## USING THE RACK

### BEFORE ATTEMPTING TO LOAD A BICYCLE CHECK:

- The rack is secured to the hitch.
- The pivot lever is fully engaged in position.

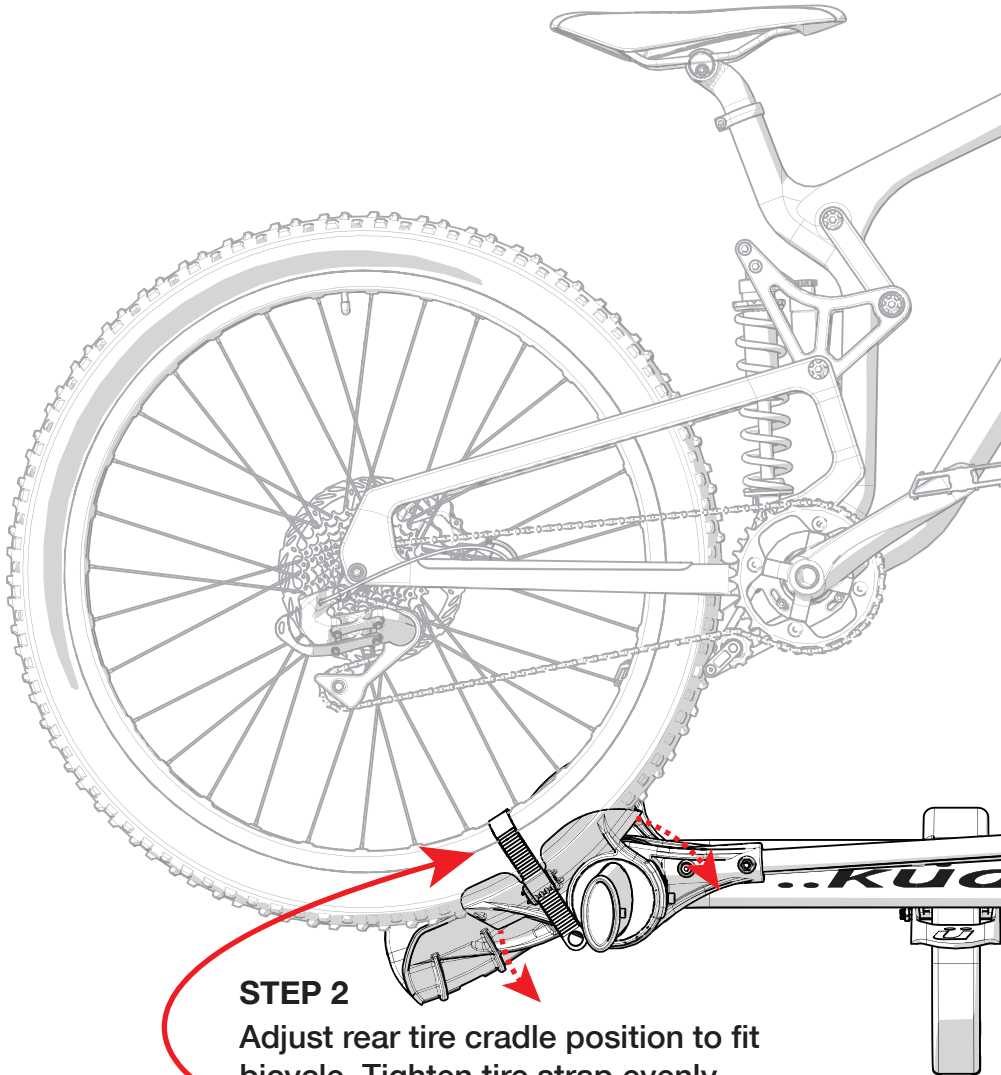

### STEP 2

Adjust rear tire cradle position to fit bicycle. Tighten tire strap evenly.



## STEP 1

Place tire hook as close as possible to fork and then ratchet the tire hook down tightly to the tire.

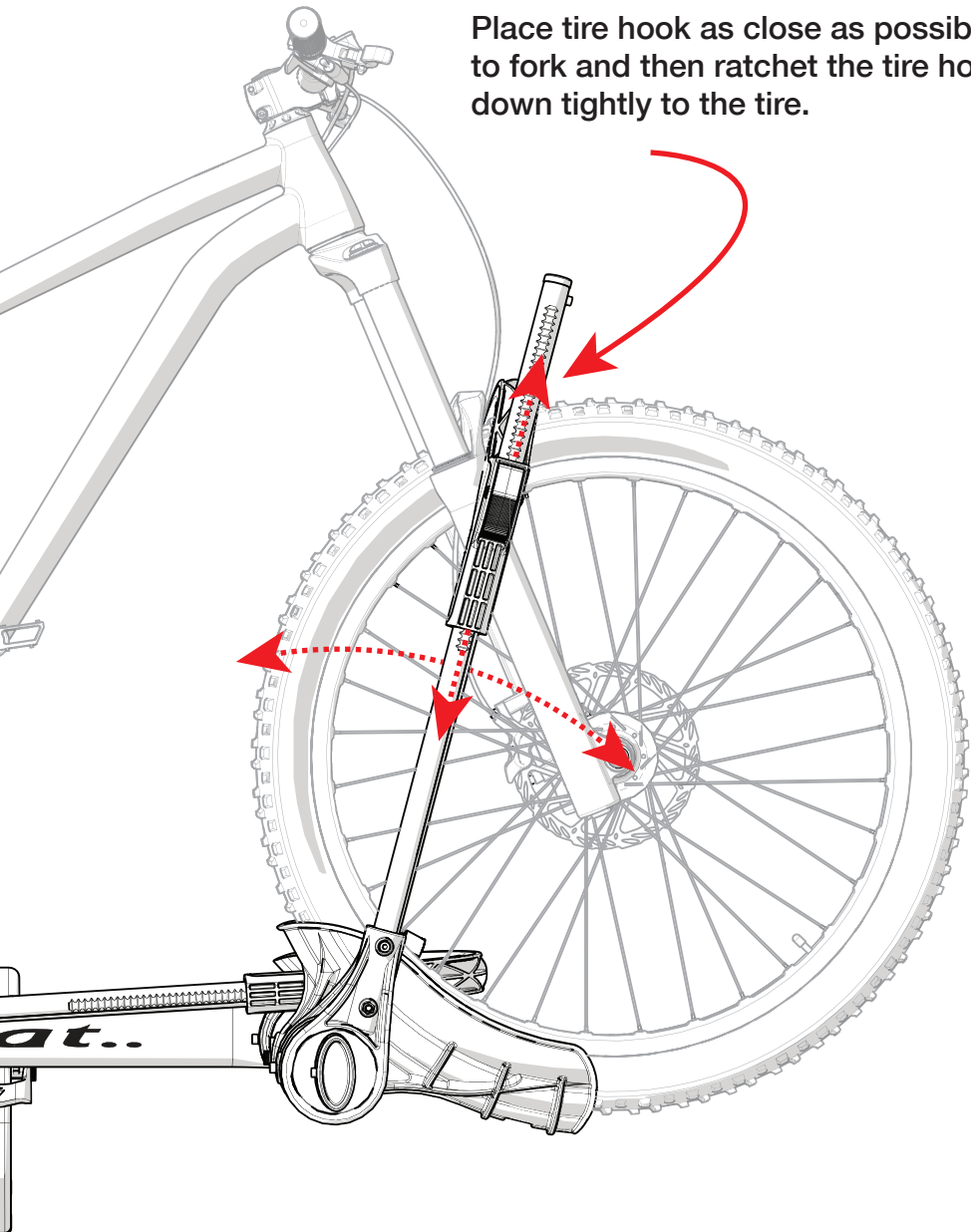

The front tire cradle bolts locator tab can be flipped upside-down to adjust the pitch of the bike for a better fit or to eliminate interference between multiple bikes.

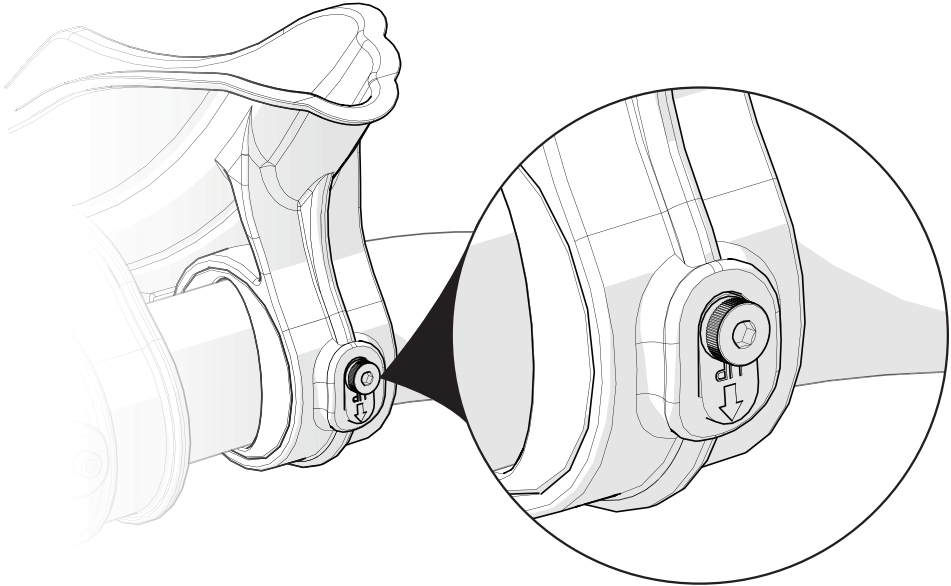

The Transfer rack pivots upward for travel and pivots down to allow trunk or hatch access.

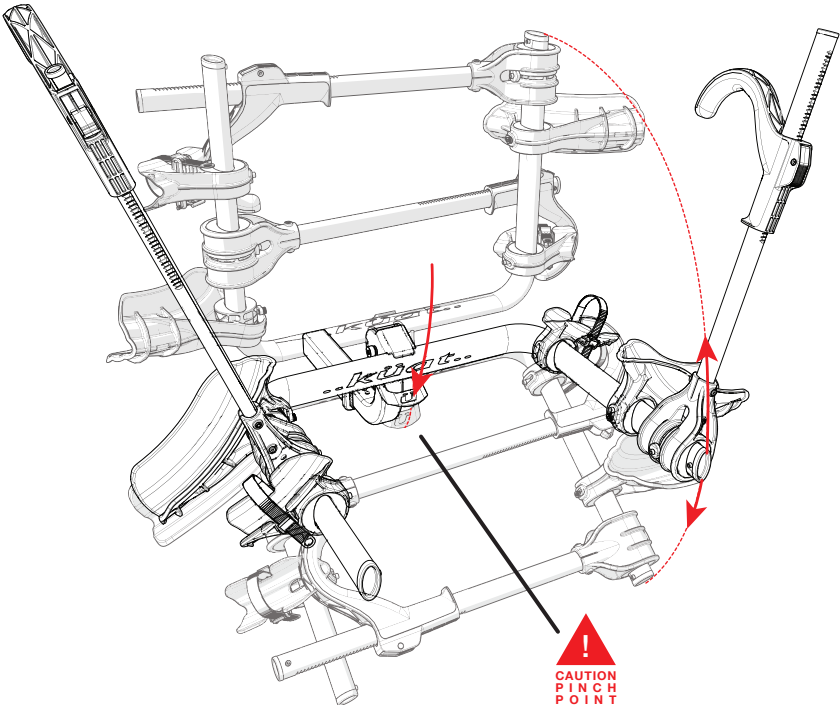

## Phat Bike Kit

Product #APBK

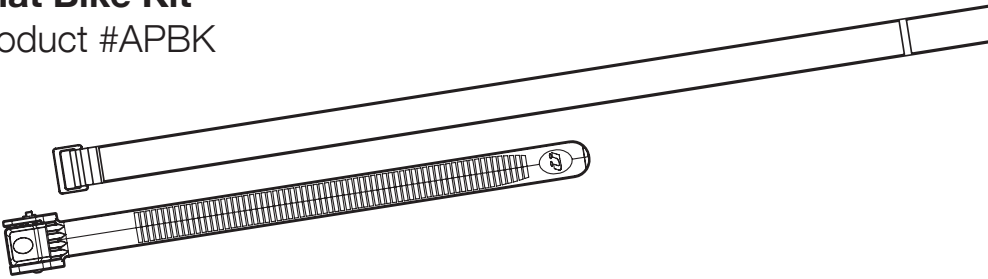

- For use with 2.75-4.25" width tires
- Compatible with the Transfer and NV racks

## Lock Kit

Product #ATSCLK12 **TRANSFER2 Kit**

Product #ATSCLK13 **TRANSFER3 Kit**

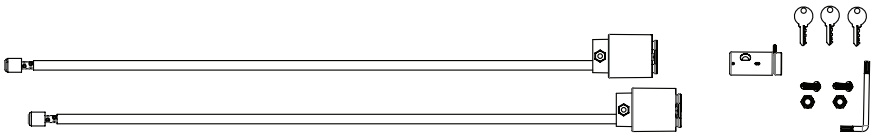

- Kit includes hitch lock and cable locks



1.877.822.5828  
info@kuatracks.com

KUATRACKS.COM /   