

YAKIMA *LITERIDER 2&3*

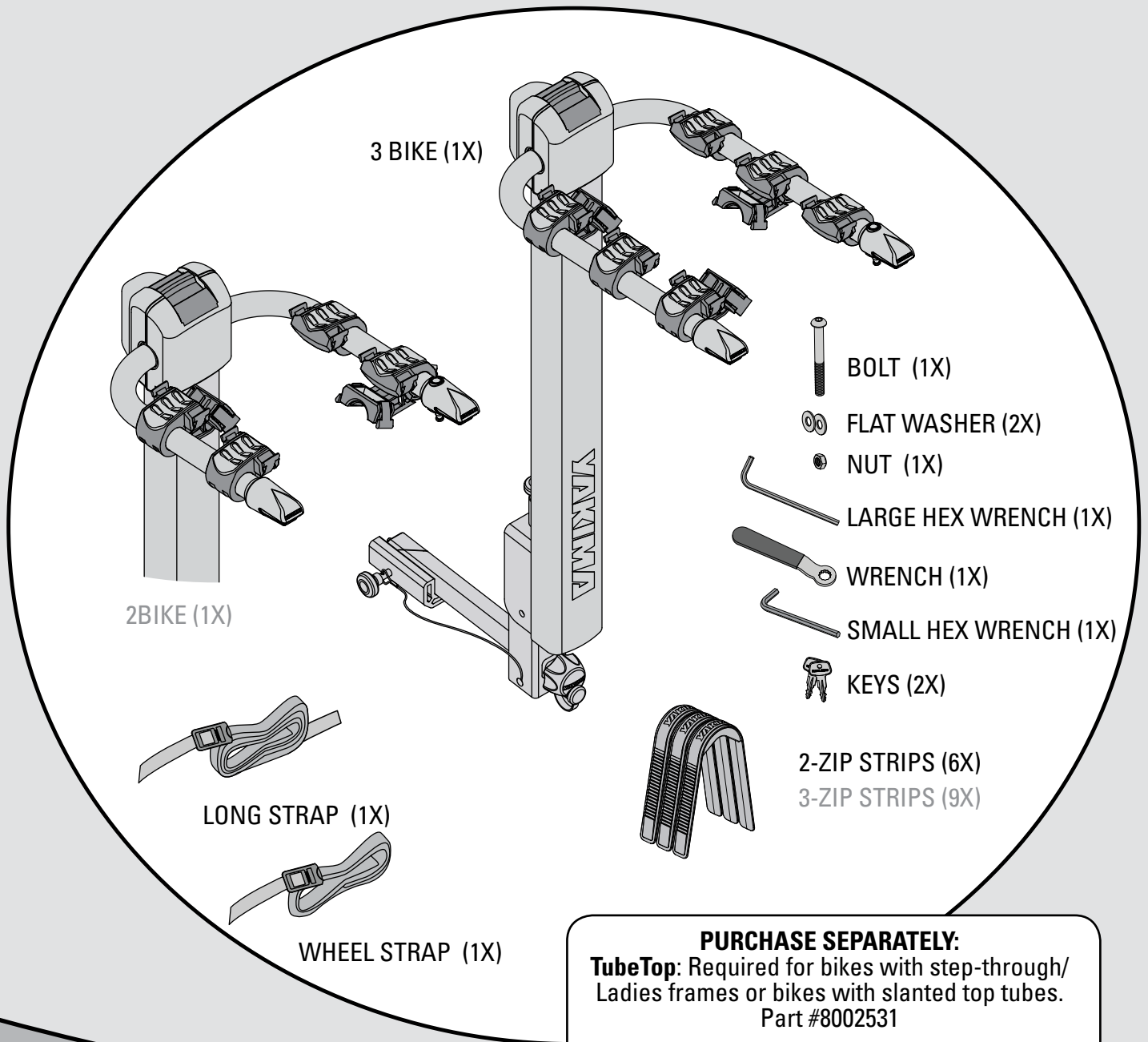

IMPORTANT WARNING

IT IS CRITICAL THAT ALL YAKIMA RACKS AND ACCESSORIES BE PROPERLY AND SECURELY ATTACHED TO YOUR VEHICLE. IMPROPER ATTACHMENT COULD RESULT IN AN AUTOMOBILE ACCIDENT, AND COULD CAUSE SERIOUS BODILY INJURY OR DEATH TO YOU OR TO OTHERS. YOU ARE RESPONSIBLE FOR SECURING THE RACKS AND ACCESSORIES TO YOUR CAR, CHECKING THE ATTACHMENTS PRIOR TO USE, AND PERIODICALLY INSPECTING THE PRODUCTS FOR ADJUSTMENT, WEAR, AND DAMAGE. THEREFORE, YOU MUST READ AND UNDERSTAND ALL OF THE INSTRUCTIONS AND CAUTIONS SUPPLIED WITH YOUR YAKIMA PRODUCT PRIOR TO INSTALLATION OR USE. IF YOU DO NOT UNDERSTAND ALL OF THE INSTRUCTIONS AND CAUTIONS, OR IF YOU HAVE NO MECHANICAL EXPERIENCE AND ARE NOT THOROUGHLY FAMILIAR WITH THE INSTALLATION PROCEDURES, YOU SHOULD HAVE THE PRODUCT INSTALLED BY A PROFESSIONAL INSTALLER.

1 Install tongue.

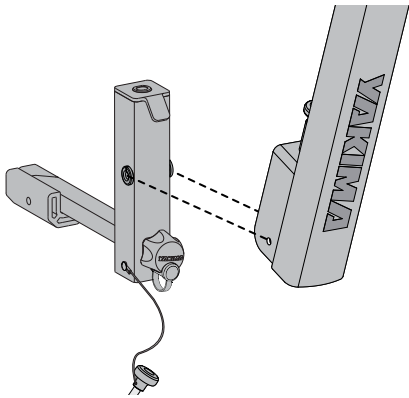

Join the tongue with the mast (with mast tilted) aligning the holes as shown. Assembly may be easier by first installing tongue in vehicle's Hitch.

2 Secure tongue.

- Install bolt and a flat washer.
- Add a second washer, attach nut.

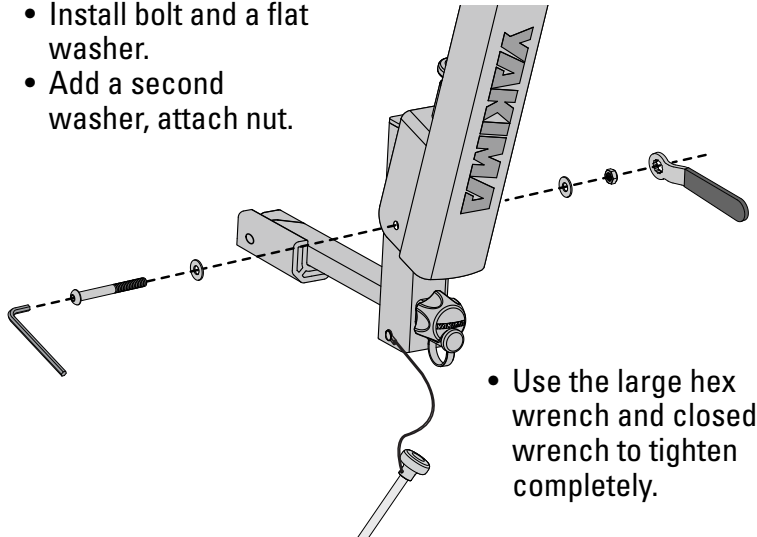

- Use the large hex wrench and closed wrench to tighten completely.

3 If your vehicle's hitch is 1 1/4": remove the 2" hitch adapter.



For 2" hitches:
proceed to next step.

Remove the screw from the adapter using the small hex wrench.

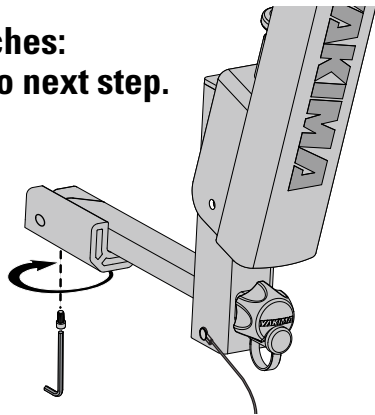

Remove the adapter from the tongue.

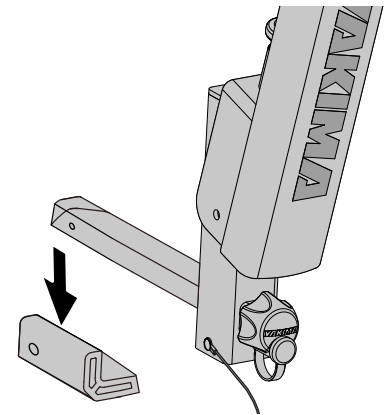

4 Insert tongue into vehicle's hitch.



IF SPARE TIRE CAUSES INTERFERENCE, DO NOT USE THIS PRODUCT!

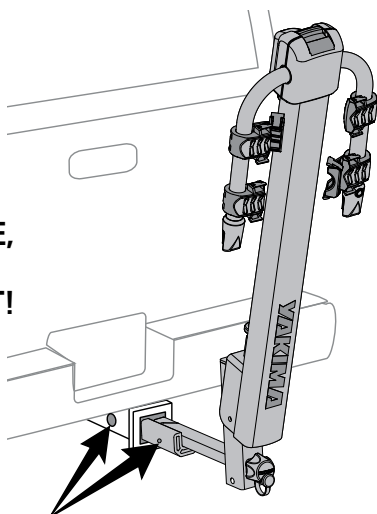

Align the holes in the receiver to the holes in the tongue.

5 Lock mast in the full upright position.

LiteRider mast must be locked in the upright position before loading bikes or moving vehicle!



6 Tighten locking knob.

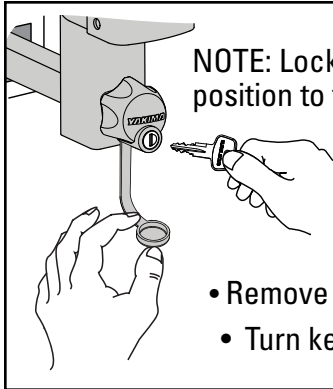

NOTE: Lock must be in unlocked position to tighten or loosen knob.

- Remove dirt guard.
- Turn key clockwise to unlock.

Safety pin is required for use.

- Insert safety pin.
- TIGHTEN knob until there is no more play between the tongue and receiver.
- Lock it.
- Replace dirt guard.

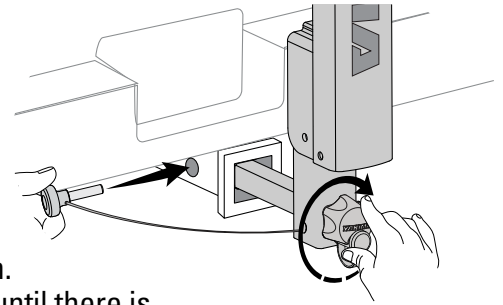

NOTE: When locked, the knob will spin freely, making it unable to be loosened.

7 Extend arms.

Pull the lever to release the arms from locked-down position.



CAUTION
Keep fingers away from ALL moving parts!

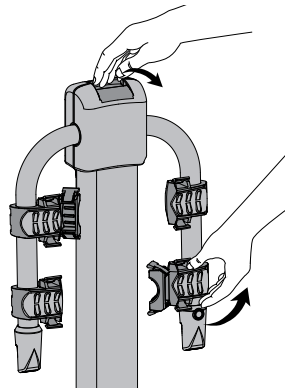

Raise arms completely.

Arms will lock into position.

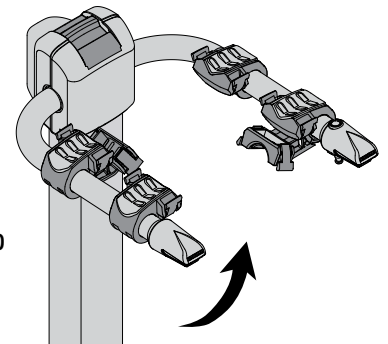

8 Load heaviest bike first.

- Always load first bike with chain away from vehicle.
- Compress stabilizers against bike frame.
- Stabilize the bike frame in the cradle. Arrange bikes for best stabilization.

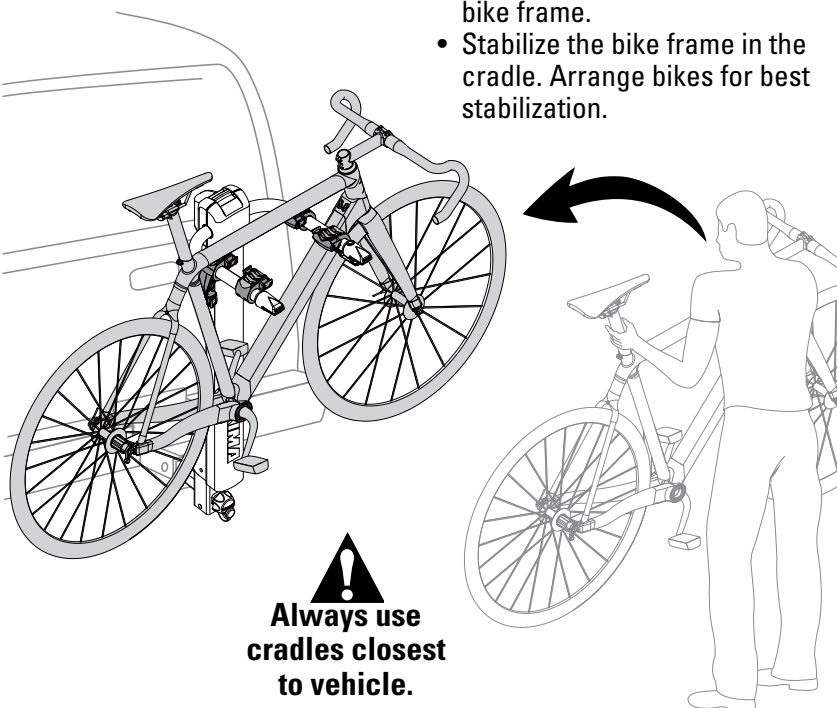

Always use cradles closest to vehicle.

A Yakima TubeTop (see cover page) may be *required* to carry your bike safely.

Failure to load bikes properly can result in property damage, personal injury, or death.

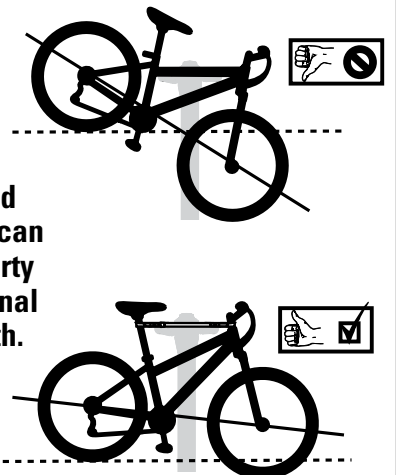

Bikes should be as level as possible to avoid ground clearance issues and possible ejections.

9 Apply Zip Strips, diagonally over frame, hook into place.

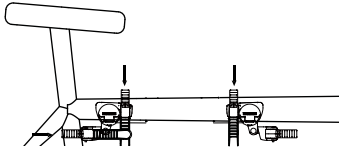
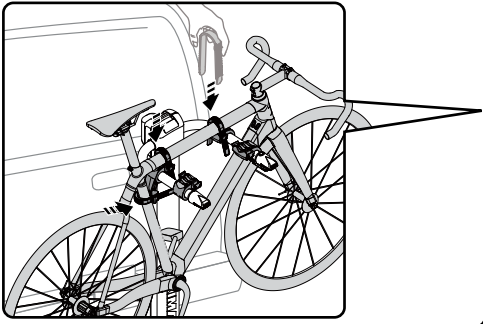

Arrange bikes for best stabilization.

Pull straps tightly over bike frame, and hook onto cradle.

Alternate bike directions to avoid interference.

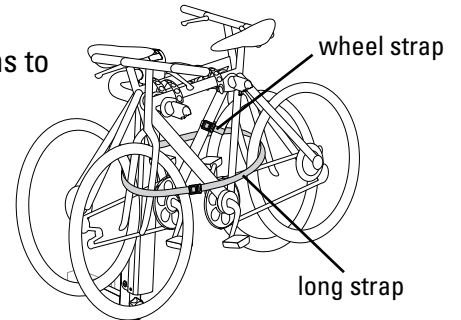

10 Load additional bikes.

- Use Wheel Strap to secure rear bike's front wheel to it's frame.
- Use Long Strap to secure bikes to LiteRider mast.
- Secure loose strap ends.

11 Fold mast down to access the rear:

- Unload the bikes.
- Push the top of the mast towards the vehicle while pulling the release knob upward simultaneously.
- Carefully fold mast down.
- When finished be sure to bring the mast to the full upright and locked position.



CAUTION: Keep fingers away from ALL moving parts!

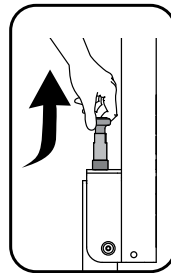

PULL

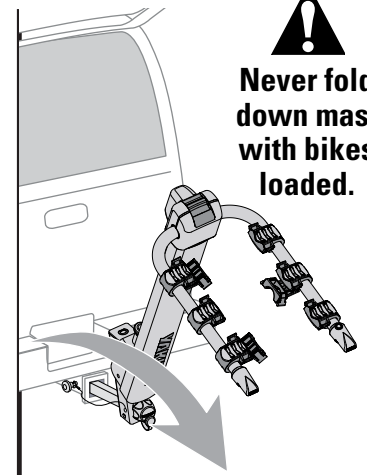
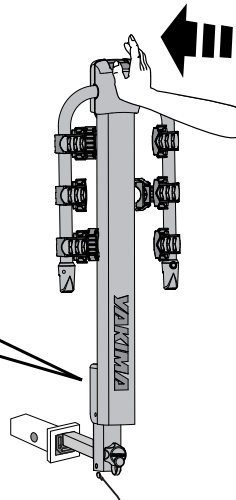

Never fold down mast with bikes loaded.



CAUTION: NEVER operate vehicle with LITERIDER in folded position! Check that release knob is in locked position by pulling on mast.

12 Fold carrier arms when not in use.

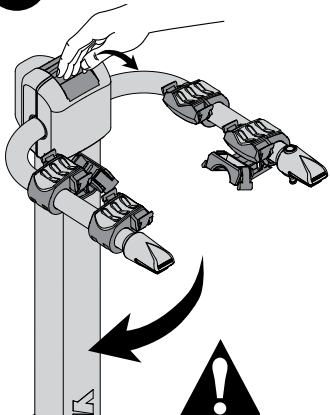

- Pull release lever forward.
- Pull up slightly on arms while pulling lever.
- Fold arms.

Be sure arms lock in down position.

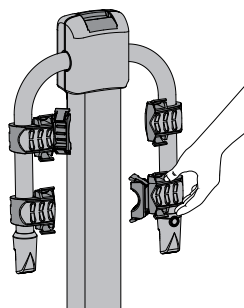

13 To lock bikes to LiteRider use lock cable.

- Access lock cable from recess at rear of mast.
- Pass cable through bike frame.
- Attach lock to pin at end of the arm.
- Lock the lock.

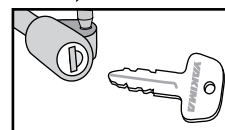
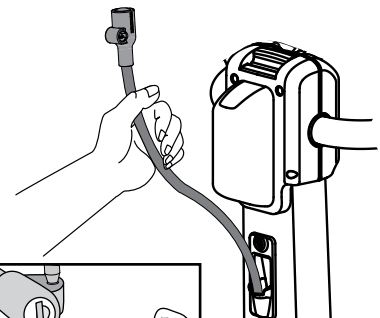
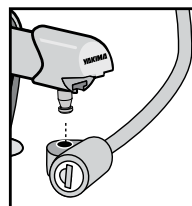

14 Perform SAFETY CHECKS

- Mast must be locked into place when operating vehicle.
- Be sure the Zip Strips are hooked securely over the bike frames.
- Replace Zip Strips if cracked or worn.
- Be sure all hardware is secured according to instructions.
- Do not let bicycle tires hang near vehicle's hot exhaust.



IF YOUR VEHICLE HAS A REAR HATCH:

On some vehicles, hatch interference is unavoidable. Use caution when opening your hatch.



LiteRider mast must be locked in place before loading bikes or moving vehicle!

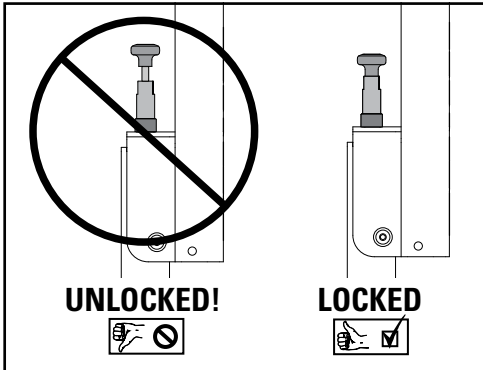

IMPORTANT LOAD LIMITS

2 Bike LiteRider - Total weight, 70 lbs./32 kg

3 Bike LiteRider- Total weight, 90 lbs./41 kg

— Use —

- Off-road driving is not recommended and could result in damage to your vehicle, hitch receiver, or your bikes.
- Do not transport bicycles with attached baby seats, panniers, wheel covers, full bike covers or motors.
- Not intended for tandem, or recumbent bikes.
- Use care when entering driveways so that bikes do not contact the ground.
- Drive slowly over speed bumps 5-10 mph (8 kph - 16 kph) max.

— Installation —

- Do not use this product with hitch extenders. Use only Yakima adapters with this product. Do not use any other brand tongue adapter.
- Do not install if spare tire causes interference.
- Do not install onto trailers, campers, or recreational vehicles.
- Remove this rack before entering an automatic car wash, and when not in use.

WARNING



Attachment hardware can loosen over time. Check before each use, and tighten if necessary. Failure to perform safety checks can result in property damage, personal injury, or death.

MAINTENANCE

Use non-water soluble lubricant on moving metal parts. Use a soft cloth with water and mild detergent to clean rubber parts.



Be sure to read all the warnings and warranty information contained in the insert accompanying these instructions!

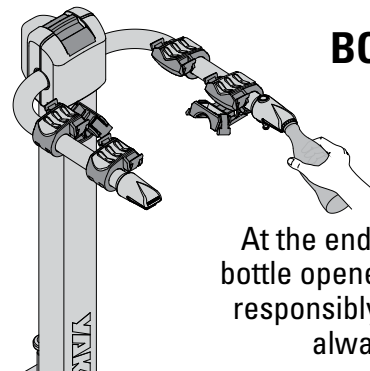

BOTTLE OPENER

At the end of each arm is a bottle opener. Be sure to drink responsibly, never litter, and always recycle.

KEEP THESE INSTRUCTIONS!